



FEMA

Forks

~ Proudly offering Pallet Forks MADE IN THE USA ~



3 Perin Road North Little Rock, AR 72118 (901)286-4200
Email: sales@femaforks.com Website: www.femaforks.com

Class 2 STD Tapered Pallet Forks

<u>SIZE</u>	<u>CAPACITY (PER PAIR)</u>
1.18x3x42	2,200
1 3/8x4x42	4,470
1 3/8x4x48	4,470
1 1/2x4x42	5,500
1 1/2x4x48	5,500
1 1/2x4x54	5,500
1 1/2x4x60	5,500
1 1/2x4x72	5,500
1 3/4x4x42	6,990
1 3/4x4x48	6,990
1 3/4x4x54	6,990
1 3/4x4x60	6,990
1 3/4x4x72	6,990
1 3/4x4x96	6,990
1 1/2x5x42	6,900
1 1/2x5x48	6,900
1 1/2x5x54	6,900
1 1/2x5x60	6,900
1 1/2x5x72	6,900
1 1/2x5x96	6,900
1 3/4x5x42	8,770
1 3/4x5x48	8,770
1 3/4x5x54	8,770
1 3/4x5x60	8,770
1 3/4x5x72	8,770
1 3/4x5x96	8,770

Please call for pricing and availability.

(901)286-4200 Email: sales@femaforks.com Website: www.femaforks.com

Class 3 STD Tapered Pallet Forks

<u>SIZE</u>	<u>CAPACITY (PER PAIR)</u>
1 1/2x5x42	6,900
1 1/2x5x48	6,900
1 1/2x5x54	6,900
1 1/2x5x60	6,900
1 1/2x5x72	6,900
1 1/2x5x96	6,900
1 3/4x5x42	8,770
1 3/4x5x48	8,770
1 3/4x5x54	8,770
1 3/4x5x60	8,770
1 3/4x5x72	8,770
1 3/4x5x96	8,770
2x5x42	11,200
2x5x48	11,200
2x5x54	11,200
2x5x60	11,200
2x5x72	11,200
2x5x96	11,200
2x6x48	13,450
2x6x60	13,450
2x6x72	13,450
2x6x96	13,450

Please call for pricing and availability.

(901)286-4200 Email: sales@femaforks.com Website: www.femaforks.com

Class 4 STD Tapered Pallet Forks

<u>SIZE</u>	<u>CAPACITY (PER PAIR)</u>
2x6x48	13,450
2x6x60	13,450
2x6x72	13,450
2x6x96	13,450
2 1/4x6x48	19,200
2 1/4x6x60	19,200
2 1/4x6x72	19,200
2 1/4x6x96	19,200
2 1/2x6x48	21,800
2 1/2x6x60	21,800
2 1/2x6x72	21,800
2 1/2x6x96	21,800

Please call for pricing and availability.

(901)286-4200 Email: sales@femaforks.com Website: www.femaforks.com

Class 2 FTP Pallet Forks

<u>SIZE</u>	<u>CAPACITY (PER PAIR)</u>
1 3/8x4x42	4,470
1 3/8x4x48	4,470
1 1/2x4x42	5,500
1 1/2x4x48	5,500
1 1/2x4x54	5,500
1 1/2x4x60	5,500
1 1/2x4x72	5,500
1 3/4x4x42	6,990
1 3/4x4x48	6,990
1 3/4x4x54	6,990
1 3/4x4x60	6,990
1 3/4x4x72	6,990
1 1/2x5x42	6,900
1 1/2x5x48	6,900
1 1/2x5x54	6,900
1 1/2x5x60	6,900
1 1/2x5x72	6,900
1 1/2x5x84	6,900
1 1/2x5x96	6,900
1 3/4x5x42	8,770
1 3/4x5x48	8,770
1 3/4x5x54	8,770
1 3/4x5x60	8,770
1 3/4x5x72	8,770

Please call for pricing and availability.

(901)286-4200 Email: sales@femaforks.com Website: www.femaforks.com

Class 3 FTP Pallet Forks

<u>SIZE</u>	<u>CAPACITY (PER PAIR)</u>
1 3/4x5x42	8,770
1 3/4x5x48	8,770
1 3/4x5x54	8,770
1 3/4x5x60	8,770
1 3/4x5x72	8,770
2x5x42	11,200
2x5x48	11,200
2x5x54	11,200
2x5x60	11,200
2x5x72	11,200
2x6x48	13,450
2x6x54	13,450
2x6x60	13,450
2x6x72	13,450

Class 4 FTP Pallet Forks

<u>SIZE</u>	<u>CAPACITY (PER PAIR)</u>
2x6x48	13,450
2x6x54	13,450
2x6x60	13,450
2x6x72	13,450

Please call for pricing and availability.

(901)286-4200 Email: sales@femaforks.com Website: www.femaforks.com

Lumber Forks

<u>SIZE</u>	<u>CAPACITY (PER PAIR)</u>
1 1/2x8x42 CL2 FTP	10,500
1 1/2x8x48 CL2 FTP	10,500
1 1/2x8x54 CL2 FTP	10,500
1 3/4x7x48 CL2 FTP	12,200
1 1/2x8x42 CL3 FTP	10,500
1 1/2x8x48 CL3 FTP	10,500
1 1/2x8x54 CL3 FTP	10,500
1 3/4x7x48 CL3 FTP	12,200

Block Forks

<u>SIZE</u>	<u>CAPACITY (PER PAIR)</u>
2x2x42 CL2	4,300
2x2x48 CL2	4,300
2x2x42 CL3	4,300
2x2x48 CL3	4,300

Miscellaneous Items

<u>ITEM</u>
CL2 Pin Kit
CL3 Pin Kit
CL4 Pin Kit

Please call for pricing and availability.

(901)286-4200 Email: sales@femaforks.com Website: www.femaforks.com

Extensions

<u>SIZE</u>
4x60
4x72
4x84
4x96
5x60
5x72
5x84
5x96
6x60
6x72
6x84
6x96

- Fork extensions width sizes listed above represent the width of fork that the extension is installed on. Actual extension is approximately 1” wider.
- Fork extensions are to only be used for load stabilization. Fork extensions are only allowed to be 1.5 times the length of the fork they are installed on.

Please call for pricing and availability.

ITA/HOOK FORKS



Company Name: _____ Phone: _____

Contact Name: _____ E-mail: _____

Truck make & model: _____ Capacity: _____

Fork dimensions

T _____

W _____

L _____

Y _____

X _____

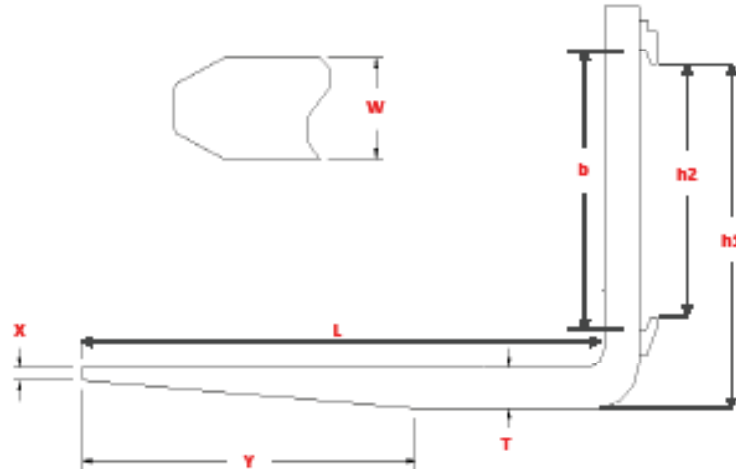

Mounting Class	Carriage Height (b)	Distance Between Hooks (h2)	Under Head Height (h1)	Select one
I A	13"	12.05"	15.50"	<input type="radio"/>
II A	16"	15.04"	18.50"	<input type="radio"/>
III A	20"	18.78"	22.36"	<input type="radio"/>
IV A	25"	23.54"	29.25"	<input type="radio"/>
V A	28.67"	26.77"	32.67"	<input type="radio"/>

For negative drop and other variations, complete below:

b _____ h2 _____ h1 _____

Extras

Comments: _____

Completed by: _____ Date: _____

BAR/PIN TYPE FORKS



Company Name: _____

Phone: _____

Contact Name: _____

E-mail: _____

Truck make & model: _____

Capacity: _____

Fork dimensions

T _____

W _____

L _____

Y _____

X _____

H _____

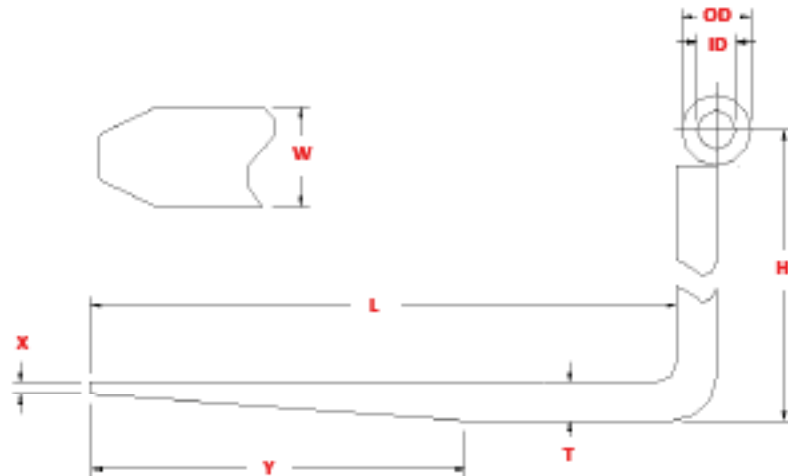

Tube details

Select one:

OD _____

ID _____



Inline*

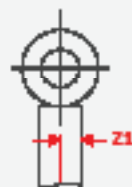

Inset (Z1) _____



Offset (Z2) _____

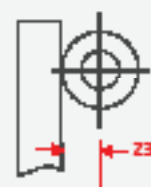

Rear shaft (Z3) _____

*no measurement needed

Extras

Bar Pin Diameter _____

Is the tube slotted or drilled? Yes No

Comments: _____

Completed by: _____ Date: _____

Fork Inspection

According to ISO 5057 / ANSI B56.1, forks in service must be inspected at least once a year by a trained professional.

Lift truck details:
Make, model and/or capacity

Fork-arm details:
Width-thickness-length

Inspection Point	Example	Result
1. Wear Original thickness (N) - 10% = replace Measure the thickness on the back of the fork (N) and compare with the heel area (M)		<input type="checkbox"/> OK <input type="checkbox"/> not OK
2. Surface Cracks Surface crack = replace <ul style="list-style-type: none"> check all welds check heel area 		<input type="checkbox"/> OK <input type="checkbox"/> not OK
3. Blade deformation/tip alignment <ul style="list-style-type: none"> $\langle d \rangle < 3\%$ of blade length = ok $\langle d \rangle > 3\%$ of blade length = replace If difference in tip heights $> 3\%$ = replace		<input type="checkbox"/> OK <input type="checkbox"/> not OK
4. Heel angle <ul style="list-style-type: none"> $\langle d \rangle = 22.00^\circ - 22.43^\circ (A = 88.9 - 90.0^\circ) = \text{ok}$ $\langle d \rangle = 22.43^\circ - 22.82^\circ (A = 91.0 - 92.9^\circ) = \text{repair}$ $\langle d \rangle > 22.82^\circ (93^\circ) = \text{replace}$ 		<input type="checkbox"/> OK <input type="checkbox"/> not OK
5. Marking, tips, suspension & locking devices <ul style="list-style-type: none"> Damaged locking system = fix / replace Bent or deformed attachments = replace Damaged tip = replace 		<input type="checkbox"/> OK <input type="checkbox"/> not OK
Final result:	<input type="checkbox"/> Fork OK <input type="checkbox"/> Fork not OK	<input type="checkbox"/> Replace <input type="checkbox"/> Repair

Inspected by: _____

Date: _____ Signature: _____

Capacity Chart



		Thickness in inches															
		1.25	1.35	1.5	1.75	2	2.36	2.5	2.75	3	3.15	3.5	4	4.15	4.5	5	
Width in inches	2	1,730	2,069	2,703	3,421	4,223											50
	2.36	2,076	2,483	3,243	4,105	5,068	7,298										60
	3.15	2,768	3,311	4,325	5,473	6,757	9,730	11,420	13,244	15,204	17,299						80
	4	3,460	4,139	5,406	6,842	8,447	12,163	14,275	16,555	19,005	21,623	27,367	33,796				100
	4.75	4,152	4,967	6,487	8,210	10,136	14,596	17,130	19,866	22,806	25,948	32,840	40,543	44,699	53,619		120
	5	4,325	5,174	6,757	8,552	10,558	15,204	17,843	20,694	23,756	27,029	34,209	42,233	46,562	55,853	65,909	125
	5.15	4,498	5,360	7,028	8,894	10,981	15,812	18,557	21,522	24,706	28,110	35,577	43,922	48,424	58,067	68,628	130
	6	5,190	6,208	8,109	10,263	12,670	18,246	21,412	24,833	28,507	32,435	41,060	50,679	55,874	67,023	79,198	150
	7	6,227	7,460	9,730	12,315	15,204	21,893	25,694	29,799	34,209	38,922	49,260	60,815	67,049	80,428	95,024	180
	8	6,919	8,278	10,312	13,683	16,893	24,326	28,549	33,111	38,010	43,246	54,734	67,572	74,499	89,365	105,582	200
	10	8,649	10,347	13,514	17,104	21,116	30,406	35,687	41,388	47,512	54,058	68,417	84,486	93,123	111,706	131,977	250
	10.75	9,341	11,175	14,586	18,473	22,806	32,840	38,542	44,899	51,313	58,383	73,890	91,223	100,573	120,642	142,536	270
	11	9,687	11,589	15,136	19,157	23,690	34,067	39,969	46,355	53,213	60,545	76,627	94,601	104,258	125,110	147,815	280
	12	10,379	12,416	16,217	20,525	25,340	36,489	42,824	49,686	57,014	64,870	82,101	101,359	111,748	134,047	158,373	300
	13.75	12,109	14,486	18,320	23,946	29,563	42,571	49,961	57,943	66,517	75,681	118,252	118,252	130,373	156,388	184,768	350
	15.75	13,839	16,555	21,323	27,367	33,796	48,652	57,099	66,221	76,019	86,493	109,467	135,145	149,997	178,729	211,164	400
	17.7	15,569	18,625	24,326	30,788	38,010	54,734	64,236	74,499	85,521	97,304	123,151	152,038	167,622	201,070	237,559	450
20	17,299	20,694	27,329	34,209	42,233	60,815	71,373	82,776	95,024	108,116	136,834	168,931	186,247	223,411	263,955	500	
		32	35	40	45	50	60	65	70	75	80	90	100	105	115	125	
		Thickness in mm															

Capacity per pair in pounds at 24" load center. For other section sizes and load center details, please call.



Customer Information:

Company: _____
 Contact Name: _____
 Phone: _____
 Fax: _____
 Email: _____

Order Information: \$ _____ +freight

Ship To: _____
 Address: _____
 City: _____ State: _____ Zip: _____
 PO#: _____
 Signature: _____
 Date: _____

1. Choose Style:

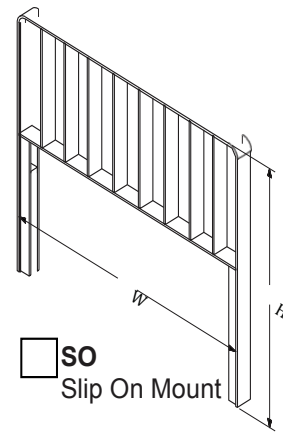
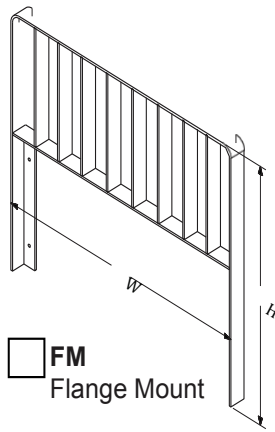
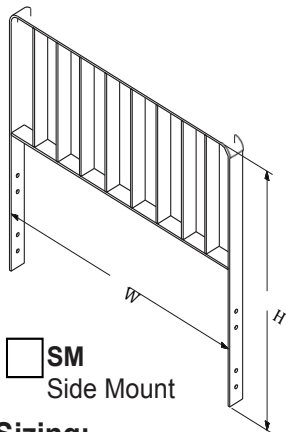

2. Sizing:

W: Carriage Width (Same as LBR width) = (in inches) _____

H: Load Backrest Height = (in inches) _____

Class: ITA Carriage Class = (II,III,IV) _____

3. Options:

Mounting Holes: Standard blank(no mounting holes) Install mounting holes

Materials: Standard(3/8" steel) Heavy duty(1/2" steel)

4. Mounting Dimensions:

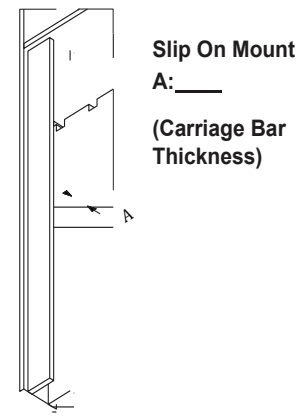
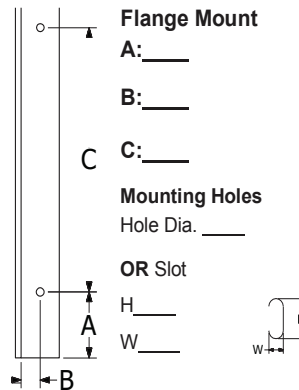
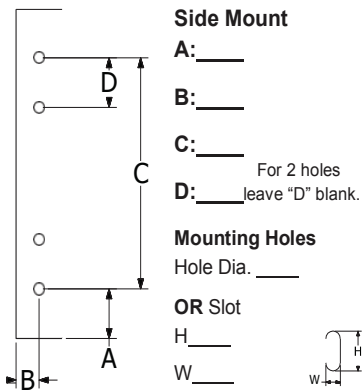

Industrial Work Platforms

For Telehandlers



- Safety restraint tie downs
- Inward swinging doors
- Large fork pockets fit tines up to 2 3/4" x 7 3/4"
- Collapsible sides for easy transportation
- Non Skid expanded metal floor
- 6 inch toe kick on all sides
- End Fork Pockets are standard on all models except the 4x4
- Meets or exceeds ANSI/OSHA Standards (B56.6-2016), & (CSA B335-04)

Model Number	Size	Capacity	Doors	Weight	List Price
MWP 4x4	4x4	1,000 lbs	One	395 lbs	Call for price
MWP 4x6	4x6	1,000 lbs	One	487 lbs	Call for price
MWP 4x8	4x8	1,000 lbs	Two	578 lbs	Call for price
MWP 4x116	4x9'8"	1,000 lbs	Two	630 lbs	Call for price

Options:

HB (High Back)	High Back option for the 4x4, 4x6, 4x8 and 4x116 (Required when the platforms are used with vertical mast forklifts)	Call for price
----------------	---	----------------

Fork Pocket Options:

Industrial Pockets	Standard Pocket size on all platforms fits Fork Tines up to 2 3/4" thick x 7 3/4" wide. Fork Pockets are centered at 38"	Standard - No Charge
Large Pockets	Optional Large Pockets Fits Fork Tines up to 3 1/2" thick x 9 1/2" wide	Call for price

NOTE: Specify Tine sizes when ordering

Made in the USA



(901)286-4200 Email: sales@femaforks.com Website: www.femaforks.com

Galvanized Work Platforms

- Galvanized Finish will keep the platform looking new for many years
- Safety restraint tie downs
- Collapsible sides for easy transportation
- Non Skid expanded metal floor
- Extra heavy floor and toe kicks
- Meets or exceeds ANSI/OSHA Standards

Made in the USA



Model Number	Size	Capacity	Doors	Weight	List Price
MWPG 4x4	4x4	1,000 lbs	One	415 lbs	Call for price
MWPG 4x6	4x6	1,000 lbs	One	522 lbs	Call for price
MWPG 4x8	4x8	1,000 lbs	Two	618 lbs	Call for price
MWPG 4x116	4x9'8"	1,000 lbs	Two	675 lbs	Call for price

NOTE: Specify Tine sizes when ordering

Handyman Platforms

- For Mast Style Forklifts
- 60" Tall High Back
- Standard pocket size 2 1/2" x 7 1/2"
- One inward swinging door
- Self Closing and Self Latching
- Meets or exceeds OSHA Standards

Made in the USA



Model Number	Size	Capacity	Weight	List Price
MHP 4x4	4x4	1,000 lbs	425 lbs	Call for price
MHP 4x6	4x6	1,000 lbs	517 lbs	Call for price

NOTE: Specify Tine sizes when ordering

Fork Mounted Swivel Hooks

- Fork Mounted Swivel Hooks for Telehandlers and Mast Style Forklifts
- Slips on Fork Tines
- Holds the hook at 24" on center
- Standard Pocket size 3 1/2" x 7 1/2"

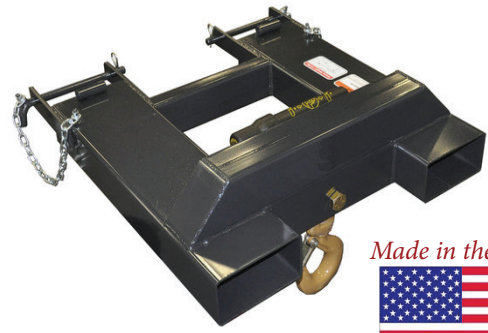

Made in the USA



Model Number	Description	Fork Pocket Spacing	Weight	List Price
MF6SH-6	6,000 lb Swivel Hook	14.50" min/30.00" max	137 lbs	Call for price
MF6SH-10	10,000 lb Swivel Hook	14.50" min/30.00" max	142 lbs	Call for price
MF6SH-14	14,000 lb Swivel Hook	14.50" min/30.00" max	147 lbs	Call for price

Wide Frame Swivel Hooks

MF6SH-10W	10,000 lb Wide Frame Swivel Hook	20.00" min/36.00" max	155 lbs	Call for price
MF6SH-14W	14,000 lb Wide Frame Swivel Hook	20.00" min/36.00" max	160 lbs	Call for price

High Capacity Swivel Hooks for Large Forklifts and Wheel Loaders

- High Capacity Swivel Hooks
- Slips on Fork Tines
- Holds the hook at 24" on center
- Standard Pocket size 3 1/2" x 9 1/2"

Made in the USA

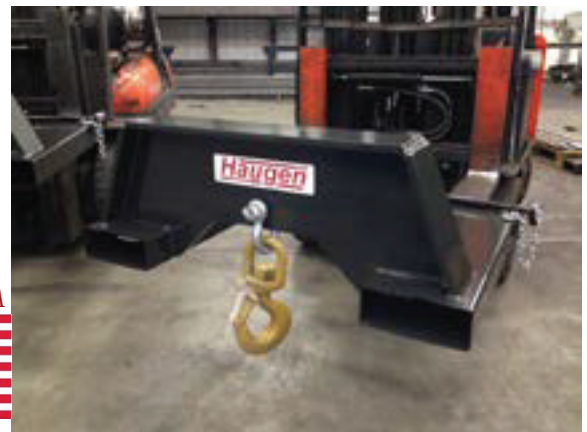

Model Number	Description	Fork Pocket Spacing	Weight	List Price
MF6SH-22	22,000 lb Swivel Hook	22.50" min/42.00" max	380 lbs	Call for price
MF6SH-30	30,000 lb Swivel Hook	22.50" min/42.00" max	395 lbs	Call for price

SMART HOOK TECHNOLOGY AVAILABLE ON THIS ATTACHMENT

(901)286-4200 Email: sales@femaforks.com Website: www.femaforks.com

Swivel Hook with a 2" Receiver

- Fork Mounted Trailer spotter for Forklifts with a 2" receiver hitch
- 6,000 lb and 10,000 lb capacity available
- Swivel Hook is held at 24" on center
- Fork Pockets fit Tines up to 3 1/2" x 7 1/2"
- Heavy Duty Construction



Model Number	Description	Weight	List Price
MF5H-6TS	3 Ton Swivel Hook with a 2" Receiver Hitch	205 lbs	Call for price
MF5H-10TS	5 Ton Swivel Hook with a 2" Receiver Hitch	220 lbs	Call for price

Fork Mounted Trailer Spotter

- The fork pockets are 48" deep and will fit tines up to 2 1/2" thick x 6 1/2" wide
- Secures to your Fork Tines with a pin
- 2" standard receiver



Model Number	Description	Weight	List Price
MFBA	Fork Slot Ball Hitch Adaptor	127 lbs	Call for price

Premium Swivel Hook

- Fork Mounted Swivel Hooks for Telehandlers
- Wide 42" frame
- Adjustable feet keep the hook off of the ground
- Slips on Fork Tines
- Holds the hook at 24" on center
- Standard Pocket size 3 1/2" x 7 1/2"

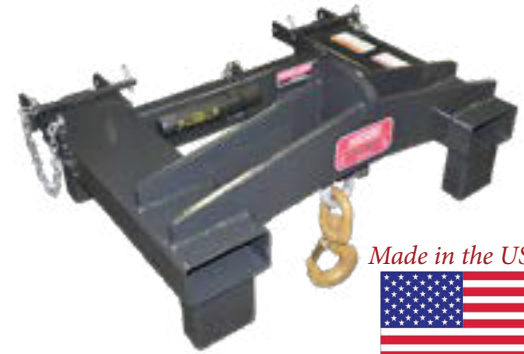

Made in the USA



Model Number	Description	Weight	List Price
M10	10,000 lb Swivel Hook - Frame and Hook only no load cell	215 lbs	Call for price
M14	14,000 lb Swivel Hook - Frame and Hook only no load cell	225 lbs	Call for price

Smart Hook

Swivel Hook with smart hook technology sends a wireless signal to a hand held monitor, tablet or cell phone. This gives the operator the weight of each load.

Monitor:

- Reads in Ton or Pounds
- Range 2,300 feet
- Operating temperature 4F to 122F (cold weather version is available)

Load Shackle:

- 14,000 lb capacity
- Accuracy +/-1% of applied load
- Battery life is 1,200 hours continuous use
- Environmentally sealed to IP 67



**New!!!
Cell Phone
App**



Made in the USA



Model Number	Description	Weight	List Price
HA-WLS 6.5t	6.5 Ton Load Shackle - This load shackle can be used with Bluetooth or a wireless monitor.	12 lbs	Call for price
HA-SW-HHP	Wireless monitor	5 lbs	Call for price



Fork Mounted Spreader Bar

- Rigid and Adjustable
- Equipped with two 5 ton swivel hooks
- Center Position is rated for 10,000 lbs with a single hook
- Outside positions combined load rated at 10,000 lb capacity
- Fits fork tines up to 3 1/2" x 7 1/2"
- Heavy Duty Construction

Model Number	Description	Capacity	Weight	List Price
MSPR 72	72" Spreader Bar	10,000 lb @ 72" 10,000 lb center position	345 lbs	Call for price
MSPR 96	96" Spreader Bar	10,000 lb @ 96" 10,000 lb center position	425 lbs	Call for price

Comes standard with two 5 ton hooks - Optional third 5 ton hook

Order Code	Description	List Price
M005	Optional Third Hook and Shackle - 5 ton Swivel Hook	Call for price

Made in the USA



(901)286-4200 Email: sales@femaforks.com Website: www.femaforks.com

Fork Mounted Spreader Bar

The Spreader Bars are Engineer Certified and come complete with a load chart.



- The fork pockets hold the Spreader Bar at 24" on center
- Fork Pockets fit tines up to 3 1/2" thick x 7 1/2" wide
- Secures to your Fork Tines with a pin
- Comes standard with two 5 ton swivel hooks
- Available sizes, 8' to 12', 10' to 15' and 13' to 20'

Model Number	Spread	Lifting Capacity	Weight	List Price
MASPR 812	Center Position - Single Point Load	10,000 lbs	580 lbs	Call for price
	Point Loads @ 65.375" spread position	5,000 x 2 = 10,000 lbs		
	Point Loads @ 97.88" spread position	4,000 x 2 = 8,000 lbs		
	Point Loads @ 121.88" spread position	3,500 x 2 = 7,000 lbs		
	Point Loads @ 145.88" spread position	3,000 x 2 = 6,000 lbs		
Model Number	Spread	Lifting Capacity	Weight	List Price
MASPR 1015	Center Position - Single Point Load	10,000 lbs	685 lbs	Call for price
	Point Loads @ 65.375" spread position	5,000 x 2 = 10,000 lbs		
	Point Loads @ 89.00" spread position	5,000 x 2 = 10,000 lbs		
	Point Loads @ 120.00" spread position	4,000 x 2 = 8,000 lbs		
	Point Loads @ 150.00" spread position	3,500 x 2 = 7,000 lbs		
	Point Loads @ 180.00" spread position	3,000 x 2 = 6,000 lbs		
Model Number	Spread	Lifting Capacity	Weight	List Price
MASPR 1320	Center Position - Single Point Load	10,000 lbs	875 lbs	Call for price
	Point Loads @ 65.375" spread position	5,000 x 2 = 10,000 lbs		
	Point Loads @ 110.00" spread position	4,000 x 2 = 8,000 lbs		
	Point Loads @ 162.00" spread position	3,500 x 2 = 7,000 lbs		
	Point Loads @ 201.00" spread position	3,000 x 2 = 6,000 lbs		
	Point Loads @ 240.00" spread position	2,250 x 2 = 4,500 lbs		

Made in the USA



(901)286-4200 Email: sales@femaforks.com Website: www.femaforks.com

Industrial Jib

- Adjustable Jib Booms for Telehandlers
- Adjusts from 4 feet to 12 feet with 8 positions
- Comes standard with one 5 Ton Crosby Eye hook and shackle
- Standard Pocket size 3 1/2" x 7 1/2"
- Easily adjusts and held with a heavy duty pin
- Position indicators ensure the operator is using the correct load chart
- Meets ANSI/OSHA Standards



Made in the USA



Model Number	Description	Capacity @ 12"	Weight	List Price
MIJ	Industrial Jib	2,050 lbs	525 lbs	Call for price
MIJ-3000	Industrial Jib Heavy Duty	2,900 lbs	640 lbs	Call for price

Upgrade and add Swivel Hooks

Order Code	Description	List Price
M001	Upgrade to one Swivel Hook for an MIJ (6,000 lb hook)	Call for price
M002	Upgrade to two Swivel Hooks for an MIJ (6,000 lb hook)	Call for price
M003	Upgrade to one 5 ton Swivel Hook for an MIJ-3000 (10,000 lb hook)	Call for price
M004	Upgrade to two 5 ton Swivel Hooks for an MIJ-3000 (10,000 lb hook)	Call for price

Capacity Chart Model - MIJ

Positions	Capacity
48"	6,000 lbs
66"	6,000 lbs
84"	4,700 lbs
96"	3,500 lbs
108"	3,100 lbs
120"	2,650 lbs
132"	2,450 lbs
144"	2,050 lbs

Capacity Chart Model - MIJ 3000

Positions	Capacity
48"	10,000 lbs
66"	8,000 lbs
84"	6,800 lbs
96"	5,350 lbs
108"	4,200 lbs
120"	3,800 lbs
132"	3,300 lbs
144"	2,900 lbs

Fork Slot Truss Jibs

- Slips on Fork Tines
- Standard Pocket size 3 1/2" x 7 1/2"
- Keeper pins are chained to the Truss Jib
- 2,000 lb capacity
- Hook type, Pintle Hitch



Made in the USA



Model Number	Description	Capacity	Weight	List Price
MFTJ 12	12' Fork Slot Truss Jib	2,000 lbs	525 lbs	Call for price
MFTJ 15	15' Fork Slot Truss Jib	2,000 lbs	575 lbs	Call for price

Fork Mounted Carpet Poles

Made in the USA



- Front mounted Fork Slot Carpet Poles
- Pole diameters available in 2.5" and 3"
- The fork pockets are 48" deep and will fit tines up to 2.5" thick x 6.5" wide
- Stress Proof or Fatigue Proof poles
- Available in 6', 9' and 10' lengths

POLE CAPACITY (LBS)							
Model Number	Pole Diameter	Pole Length	Pole Material	Pole Tip	1/2 Pole Length	Total Cap (PLF)	List Price
MFCP 72-25	2.50"	6'	Stress Relieved	1,500	3,000	500	Call for price
MFCP 108-25	2.50"	9'	Stress Relieved	950	1,900	210	Call for price
MFCP 120-25	2.50"	10'	Stress Relieved	800	1,600	150	Call for price
MFCP 72-30	3.00"	6'	Stress Relieved	2,600	5,200	860	Call for price
MFCP 108-30	3.00"	9'	Stress Relieved	1,700	3,400	370	Call for price
MFCP 120-30	3.00"	10'	Stress Relieved	1,400	2,800	270	Call for price

(901)286-4200 Email: sales@femaforks.com Website: www.femaforks.com

Fork Mounted Carpet Poles “Low Rider”

- Heavy Duty Back Plates
- Rounded Tips



- Pole is carried 18” below the fork pockets
- Pole diameter available in 2.5” and 3”
- The fork pockets are 18” deep and will fit tines up to 2.25” thick x 6.25” wide
- Stress Relieved poles
- Available in 6’, 9’, 10’6” and 12’ lengths

POLE CAPACITY (LBS)							
Model Number	Pole Diameter	Pole Length	Pole Material	Pole Tip	1/2 Pole Length	Total Cap (PLF)	List Price
MUCP 72-25	2.50”	6’	Stress Relieved	1,500	3,000	500	Call for price
MUCP 108-25	2.50”	9’	Stress Relieved	950	1,900	210	Call for price
MUCP 126-25	2.50”	10’6”	Stress Relieved	800	1,600	150	Call for price
MUCP 144-25	2.50”	12’	Stress Relieved	700	1,400	110	Call for price
MUCP 72-30	3.00”	6’	Stress Relieved	2,600	5,200	860	Call for price
MUCP 108-30	3.00”	9’	Stress Relieved	1,700	3,400	370	Call for price
MUCP 120-30	3.00”	10’6”	Stress Relieved	1,400	2,800	270	Call for price
MUCP 144-30	3.00”	12’	Stress Relieved	1,200	2,400	200	Call for price

Made in the USA



(901)286-4200 Email: sales@femaforks.com Website: www.femaforks.com

Carriage Mounted Carpet Poles ~ Class 2 and 3

- Heavy Duty Back Plates
- Rounded Tips
- Class 2 or 3 carriage mount
- Pole diameter available in 2.5" and 3"
- Bolt-on Replaceable clips
- Replaceable Poles, held by set screws
- Choose from Stress Relieved Poles
- Available in 6', 9', 10'6" and 12' length



Made in the USA



POLE CAPACITY (LBS)								
Model Number	Mount	Pole Diameter	Pole Length	Pole Material	Pole Tip	1/2 Pole Length	Total Cap (PLF)	List Price
MCP 72-25 C2	Class 2	2.50"	6'	Stress Relieved	1,500	3,000	500	Call for price
MCP 108-25 C2	Class 2	2.50"	9'	Stress Relieved	950	1,900	210	Call for price
MCP 126-25 C2	Class 2	2.50"	10'6"	Stress Relieved	800	1,600	150	Call for price
MCP 144-25 C2	Class 2	2.50"	12'	Stress Relieved	700	1,400	110	Call for price
MCP 72-30 C2	Class 2	3.00"	6'	Stress Relieved	2,600	5,200	860	Call for price
MCP 108-30 C2	Class 2	3.00"	9'	Stress Relieved	1,700	3,400	370	Call for price
MCP 126-30 C2	Class 2	3.00"	10'6"	Stress Relieved	1,400	2,800	270	Call for price
MCP 144-30 C2	Class 2	3.00"	12'	Stress Relieved	1,200	2,400	200	Call for price
MCP 72-25 C3	Class 3	2.50"	6'	Stress Relieved	1,500	3,000	500	Call for price
MCP 108-25 C3	Class 3	2.50"	9'	Stress Relieved	950	1,900	210	Call for price
MCP 126-25 C3	Class 3	2.50"	10'6"	Stress Relieved	800	1,600	150	Call for price
MCP 144-25 C3	Class 3	2.50"	12'	Stress Relieved	700	1,400	110	Call for price
MCP 72-30 C3	Class 3	3.00"	6'	Stress Relieved	2,600	5,200	860	Call for price
MCP 108-30 C3	Class 3	3.00"	9'	Stress Relieved	1,700	3,400	370	Call for price
MCP 126-30 C3	Class 3	3.00"	10'6"	Stress Relieved	1,400	2,800	270	Call for price
MCP 144-30 C3	Class 3	3.00"	12'	Stress Relieved	1,200	2,400	200	Call for price

(901)286-4200 Email: sales@femaforks.com Website: www.femaforks.com



Warranty Terms

Farm Equipment & Machinery Accessories, LLC. (FEMA) warrants that for a period of one (1) year from the purchase date, FEMA products you have purchased will (a) perform in accordance with published specifications, and (b) will be free from defects in materials or workmanship. In the event a FEMA product does not meet this warranty, subject to the conditions set forth in these terms and conditions, FEMA's sole obligation will be, at its election, to repair the FEMA product in question, replace the product in question or to refund the purchase price.

This warranty will not apply to any FEMA products that have been (a) neglected, altered, abused, or used for a purpose other than the purpose for which they were provided, (b) repaired by you or any other party without FEMA's prior written authorization, or (c) otherwise used in a manner inconsistent with any instructions provided by FEMA.

In the event that FEMA repairs or replaces a defective FEMA product under warranty, the repaired or replaced product will be covered through the end of the original warranty period. No repair or replacement will extend the warranty terms.

This warranty contains the entire agreement between you and FEMA with respect to any warranty matters, and supersedes any and all other written or oral statements, representations of agreements relating to the subject matter of this warranty, except that (if applicable) the terms and conditions of any other warranty or service agreement between you and FEMA that explicitly supplements or incorporates, and does not replace or modify, the terms and conditions of this warranty will also apply to the FEMA products that you have purchased. To the extent any other warranty or service agreement between you and FEMA expressly replaces or modifies the terms and conditions of this warranty, such replaced or modified terms shall not apply unless accepted by you (or your distributor, if applicable) and FEMA in a signed agreement (e.g., the Extended Warranty Services Agreement). If you purchased the FEMA products from a party other than FEMA, FEMA reserves the right to require proof of purchase to verify the timeliness of your request.